

DIA. 2.0MM/2.5MM DC POWER JACK (11)

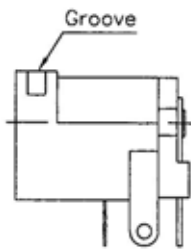

**W/O Groove
Flat Type**

**With Groove
Flat Type**

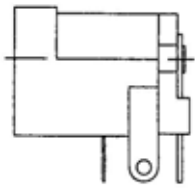
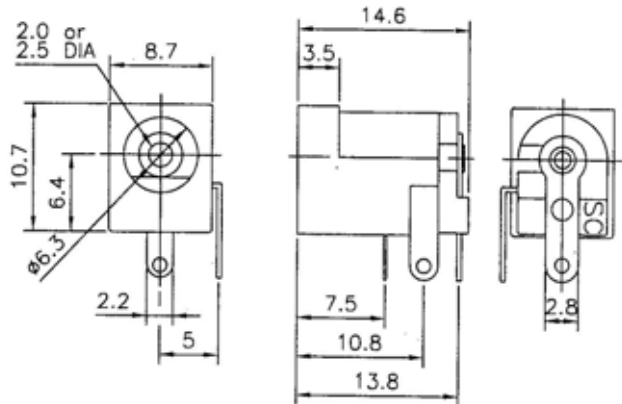
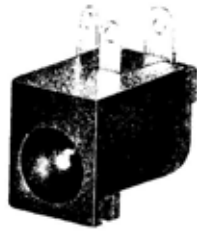
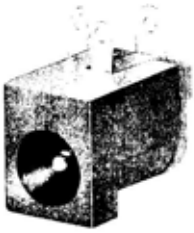
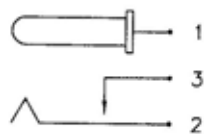
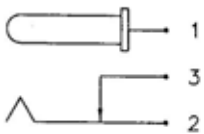

**SCHEMATIC
(NORMAL CLOSE)**

**SCHEMATIC
(NORMAL OPEN)**

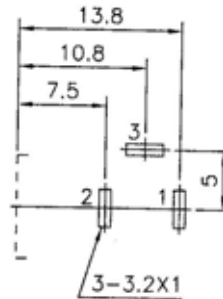

**PIN HOLE LAYOUT
(BOTTOM VIEW)**

SPECIFICATION

1. Rating: 2A 16VDC
2. Withstanding voltage:
AC 500V, 60Hz for 1 minute
3. Insulation resistance (initial):
100M Ω (min.) at 500V DC
4. Contact resistance (initial):
30m Ω (max.) at AC 100mA (max.) 1 KHz

ORDERING INFORMATION:

W/O GROOVE FLAT TYPE:

P/N DC20-09
P/N DC25-09
 DIA. 2.0MM/DIA. 2.5MM
 DC POWER JACK
 NORMAL CLOSE
P/N DC20-25
P/N DC25-25
 DIA. 2.0MM/DIA. 2.5MM
 DC POWER JACK
 NORMAL OPEN

ORDERING INFORMATION:

WITH GROOVE FLAT TYPE:

P/N DC20-10
P/N DC25-10
 DIA. 2.0MM/DIA. 2.5MM
 DC POWER JACK
 NORMAL CLOSE
P/N DC20-26
P/N DC25-26
 DIA. 2.0MM/DIA. 2.5MM
 DC POWER JACK
 NORMAL OPEN