



Single Keys

1 - Pole

Types
ST 1034
ST 1034D
ST 1034E

Mechanical Data

Travel: 0.6 ± 0.1 mm
 Operating force: $0.8 \div 2.5$ N
 Permissible force at end stop: 50 N (1 min max)
 Contact bouncing: ≤ 0.5 ms
 Life: $\geq 1,000,000$ cycles
 Weight: ~ 1 g

Electrical Data

Breaking capacity: 20 mA - 30 VDC
 Contact resistance: ≤ 25 m Ω
 Insulation resistance: ≥ 1 G Ω
 Rated temperature range: -20°C to $+70^\circ\text{C}$

Features:

- Short travel
- Momentary switch with "click-effect"
- Self-cleaning contact
- Suitable for keyboards arrangement.

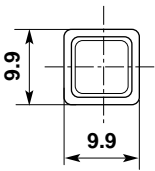
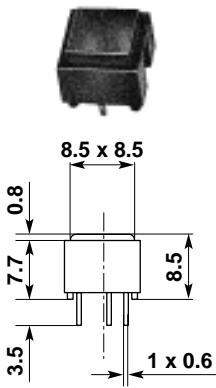

ST 1034
1-pole

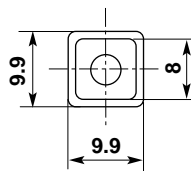
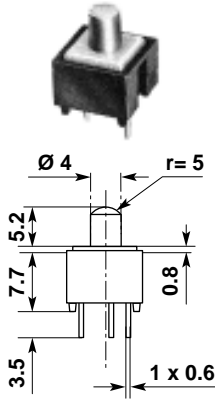

ST 1034D
1-pole

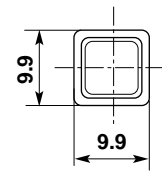
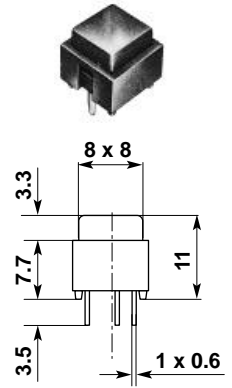

ST 1034E
1-pole

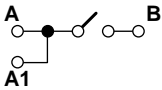

Button colour
 Standard: black
 Optional: light grey, red, yellow, blue, green
 Case colour: black

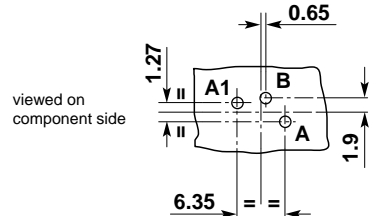



Single Keys

1 - Pole

Type
ST 1034F

Mechanical Data

Travel:	0.6 ± 0.1 mm
Operating force:	$0.8 \div 2.5$ N
Permissible force at end stop:	50 N (1 min max)
Contact bouncing:	≤ 0.5 ms
Life:	$\geq 1,000,000$ cycles
Weight:	~ 1.10 g

Electrical Data

Breaking capacity:	20 mA - 30 VDC
Contact resistance:	≤ 25 m Ω
Insulation resistance:	≥ 1 G Ω
Rated temperature range:	-20°C to $+70^{\circ}\text{C}$

Features:

- Short travel
- Momentary switch with "click-effect"
- Self-cleaning contact
- Suitable for keyboards arrangement

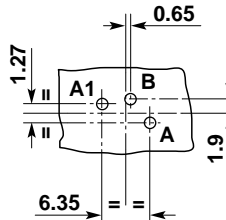
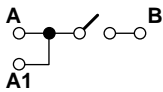
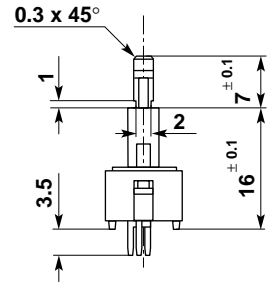
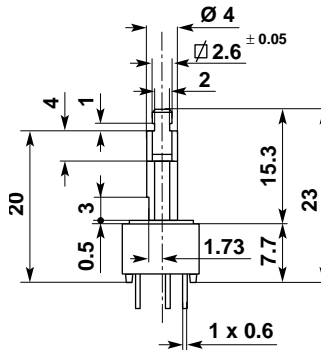

viewed on component side

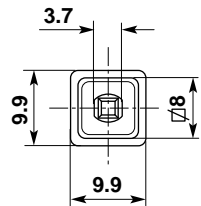

ST 1034F
1-pole

Button colour

- Standard: black
Optional: light grey, red, yellow, blue, green
Case colour: black



Single Keys

1-Pole & 2-Pole

Type
ST 1044
ST 1042

Mechanical data

Travel: 0.6 ± 0.1 mm
 Operating force: $0.8 \div 2.5$ N
 Permissible force at end stop: 50 N (1 min max)
 Contact bouncing: ≤ 0.5 ms
 Life: $\geq 1,000,000$ cycles
 Weight: ~ 1.35 g

Electrical data

Breaking capacity: 20 mA - 30 VDC
 Contact resistance: ≤ 25 m Ω
 Insulation resistance: ≥ 1 G Ω
 Rated temperature range: -20°C to $+70^{\circ}\text{C}$

Features

- Short travel
- Momentary switch with "click-effect"
- Self-cleaning contact
- Suitable for keyboards arrangement

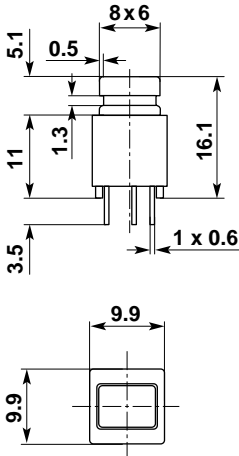

ST 1044
1-pole

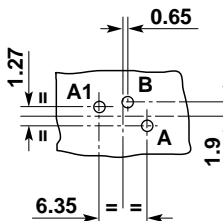
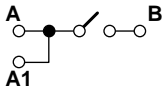

viewed on
component side

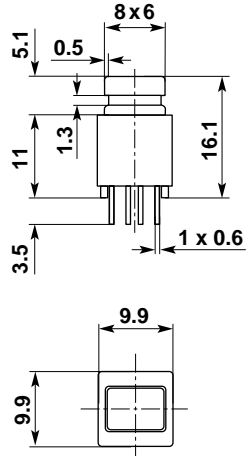

ST 1042
2-pole

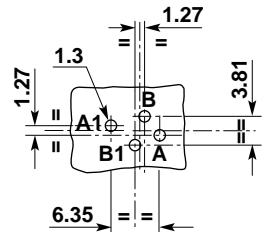

Button colour

Standard: black
 Optional: light grey, red, yellow, blue, green
 Case colour: black

